

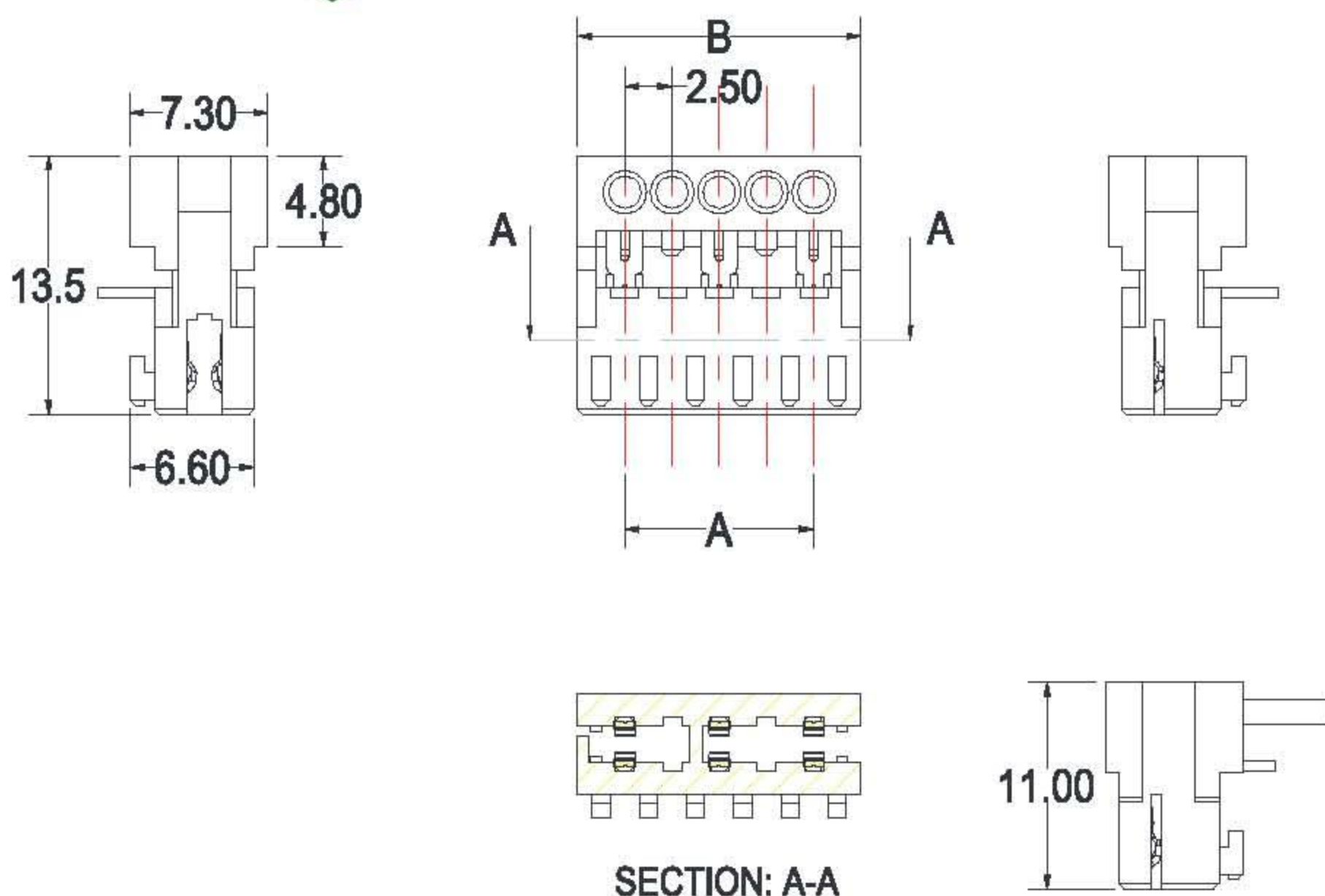

# M7289

## SPECIFICATION

Current rating: 3AAC, DC  
 Voltage rating: 32VAC, DC  
 Operating Temperature: -40°C--+120°C  
 Contact Resistance: 10mΩ max.  
 Insulation resistance: 1000MΩ min.  
 Withstanding voltage: 1400V AC/minute  
 Material: Housing: Nylon66 UL94V-0  
 Terminal: Phosphor bronze, Tin-plated  
 Wire range: AWG 24 to 22  
 GWT: 750°C IEC-60335-1

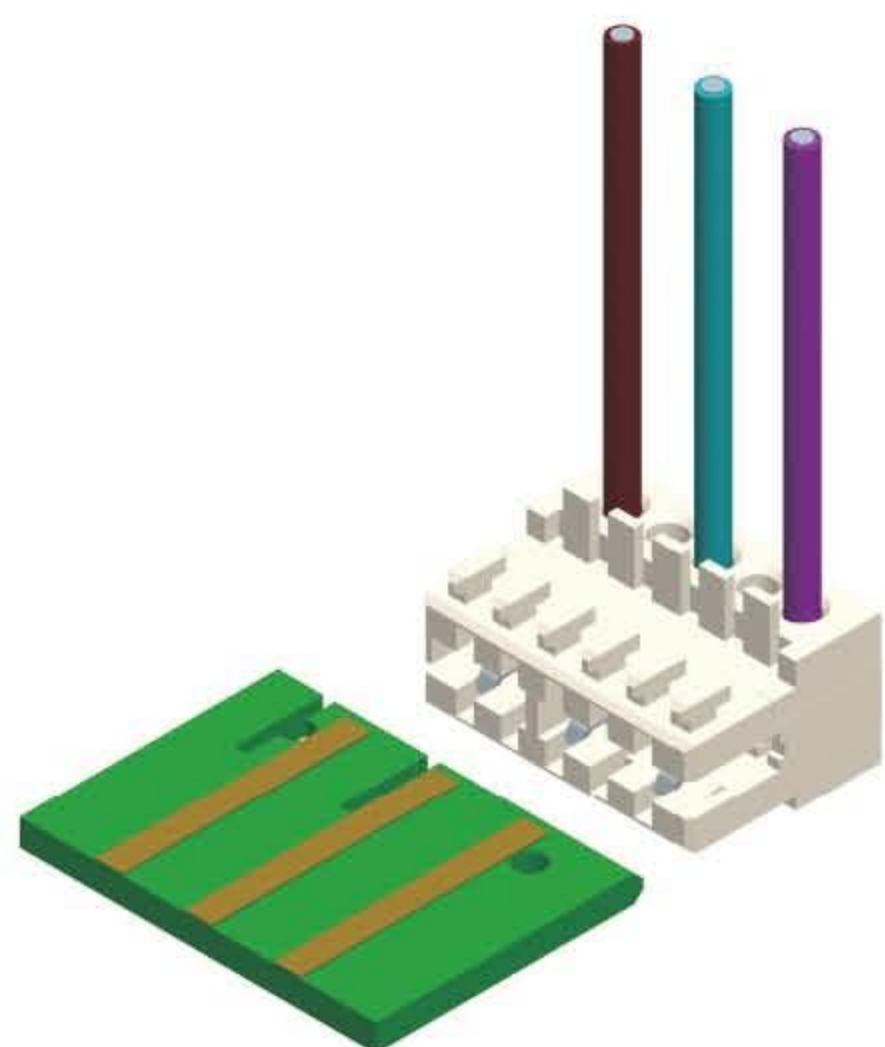

| Dimension |      |      |
|-----------|------|------|
| Pos. No.  | A    | B    |
| 3         | 5.0  | 10.0 |
| 5         | 10.0 | 15.0 |
| 7         | 15.0 | 20.0 |
| 9         | 20.0 | 25.0 |
| 11        | 25.0 | 30.0 |
| 13        | 30.0 | 35.0 |
| 15        | 35.0 | 40.0 |
| 17        | 40.0 | 45.0 |
| 19        | 45.0 | 50.0 |

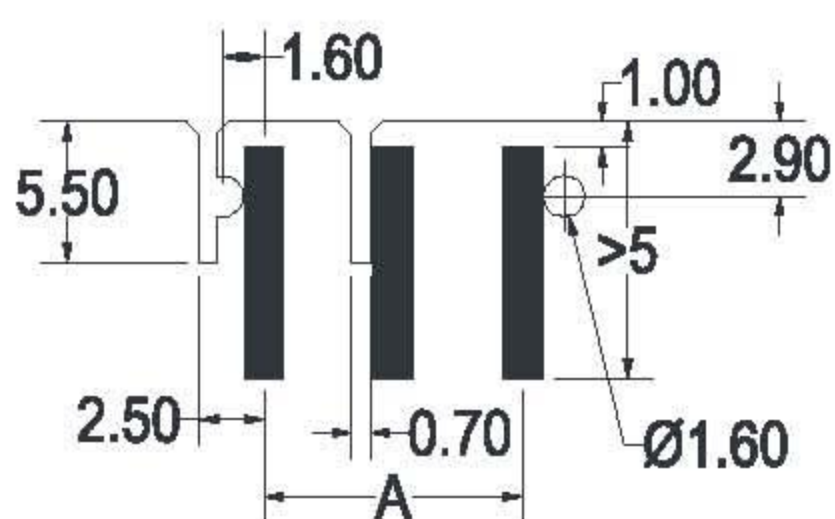

PCB Layout

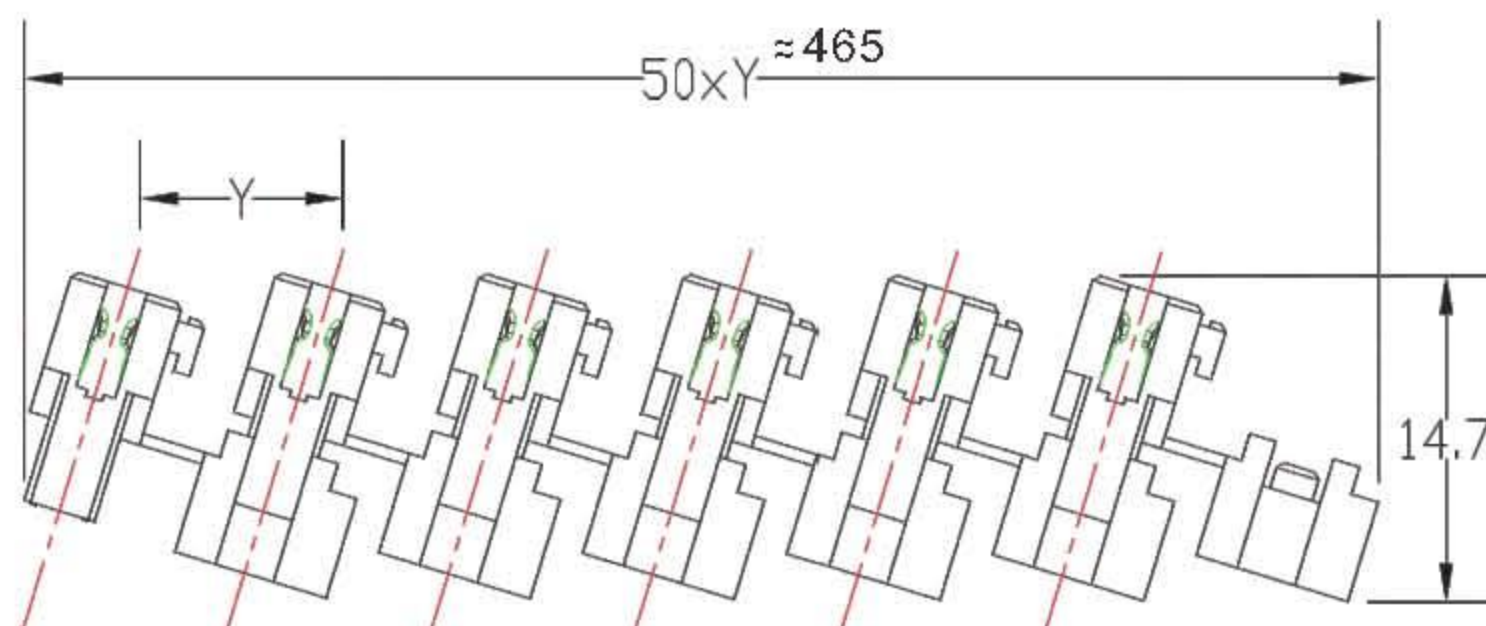
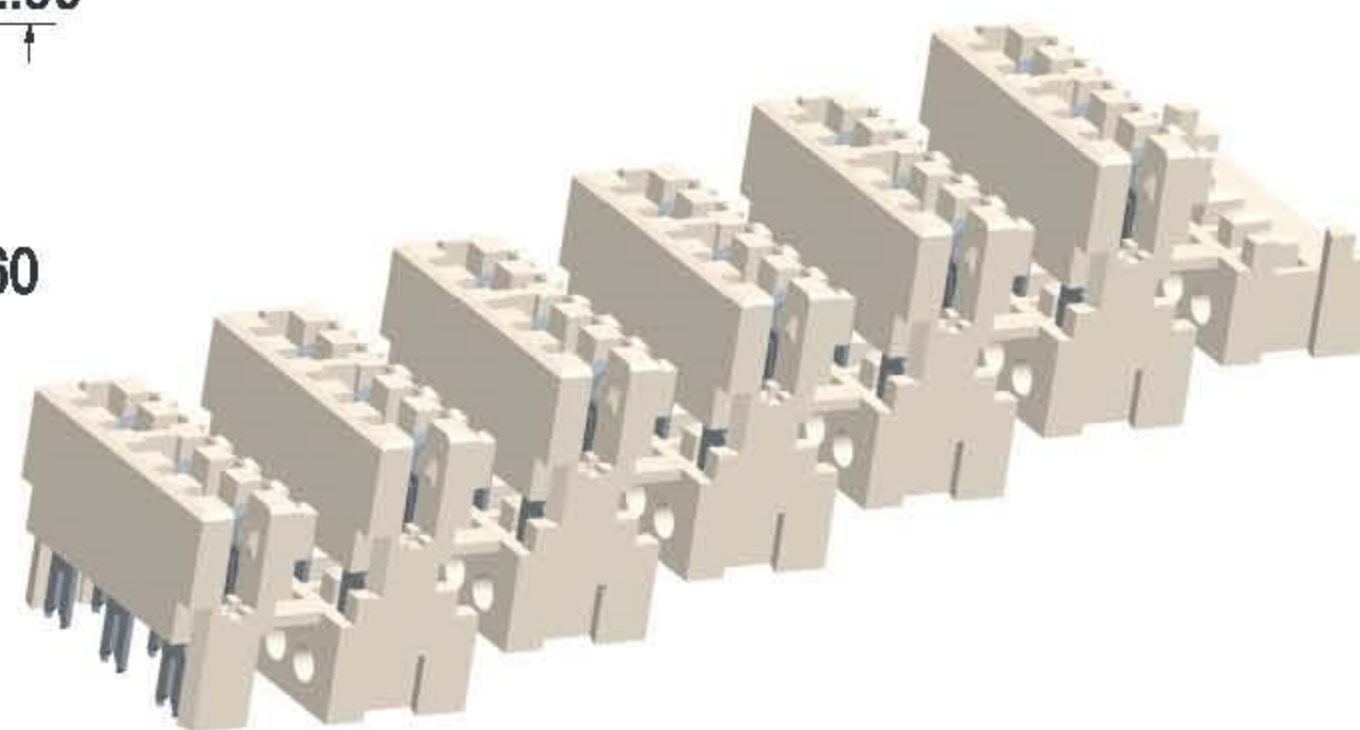

## M7289 Part Number Definition

M7289-X-X X-X-X(X)

